



6/2024

# Työmaatilat

**Kokonaisuus** rakennetaan työmaan tilatarpeiden mukaan sosiaali- ja toimistotiloista tarvittavilla kalusteilla ja käyttövalmiiksi asennettuina.

Katso työmaatilojen tarkemmat tiedot sivulta kaksi. Ohessa esimerkki tilakokonaisuudesta.

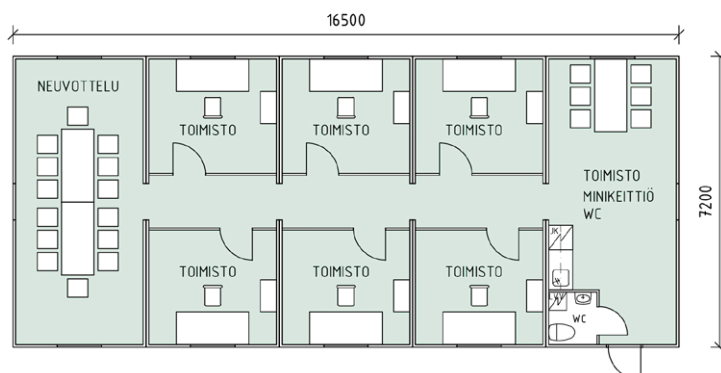



# Sosiaalitilat

Mallit sosiaalitila 3,3 x 7,2 m

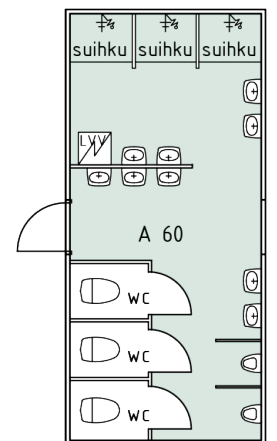
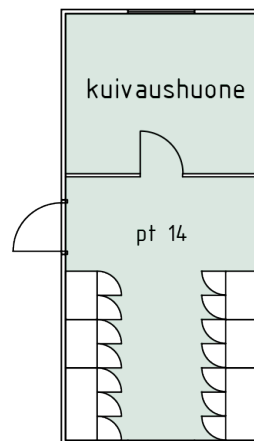
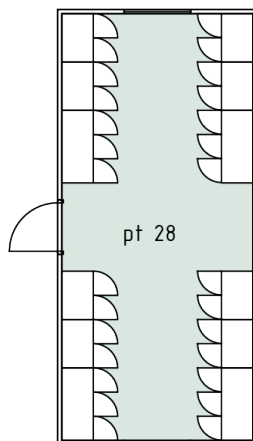
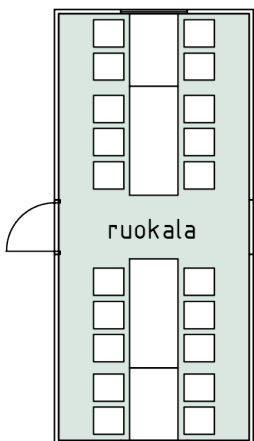
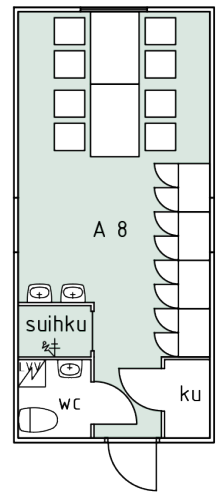
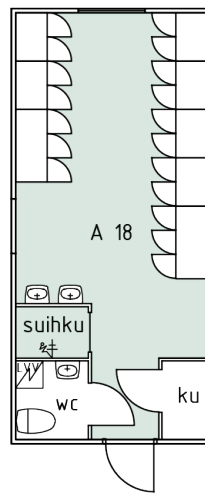
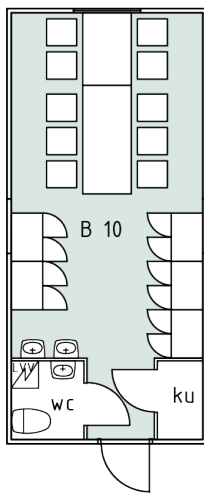
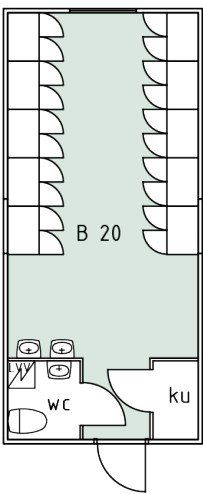



## Toimistotilat

Mallit toimistotila 3,3 x 7,2 m

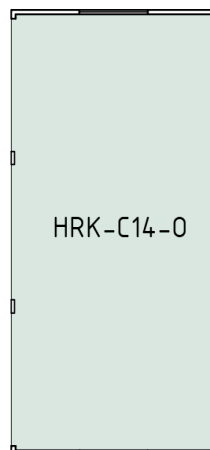
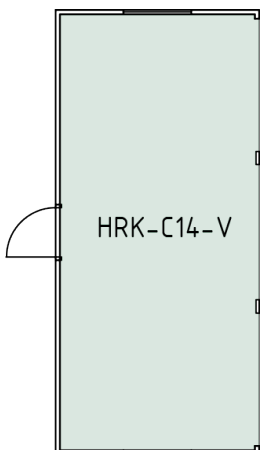
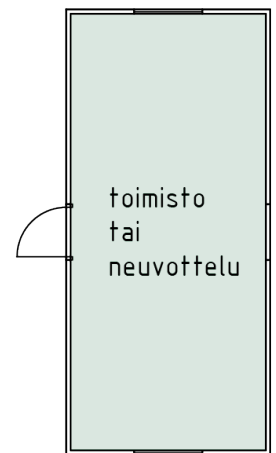
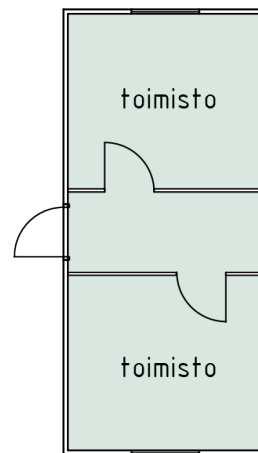
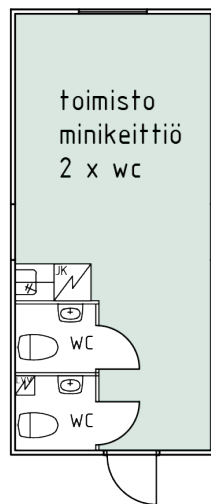
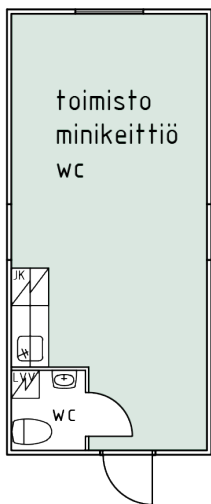



## Toimistot ja sosiaalilat Containex

### Toimistot ja sosiaalilat Containex 2,4 x 6,1 m

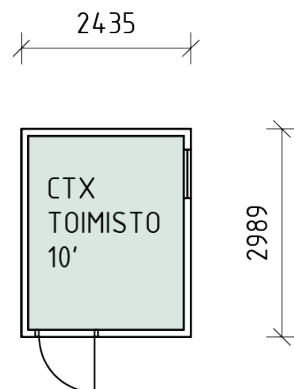

CTX SA 20' Sos.tila 40 hlö

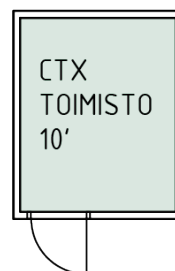
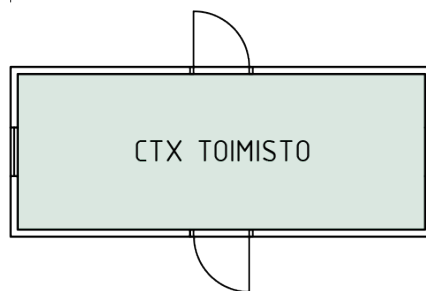
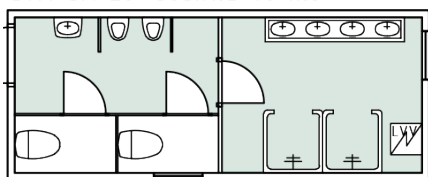

CTX 20' 3-osainen linjas.

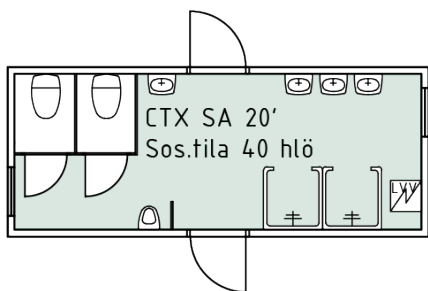
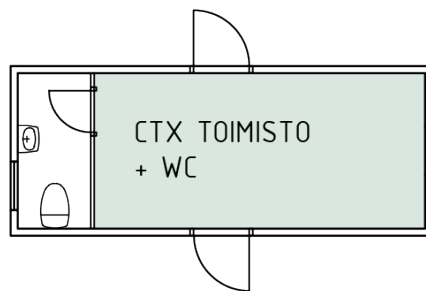
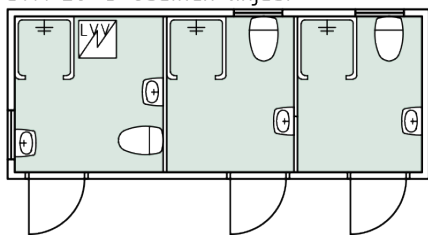

CTX SA 20' WC 6kpl

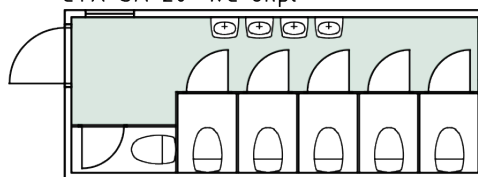

# Kuvia erilaisista työmaatioista



Kuivaushuone



Toimisto



WC ja suihkutilat

# Kuvia kootuista työmaatilosta

## Sosiaalitalat

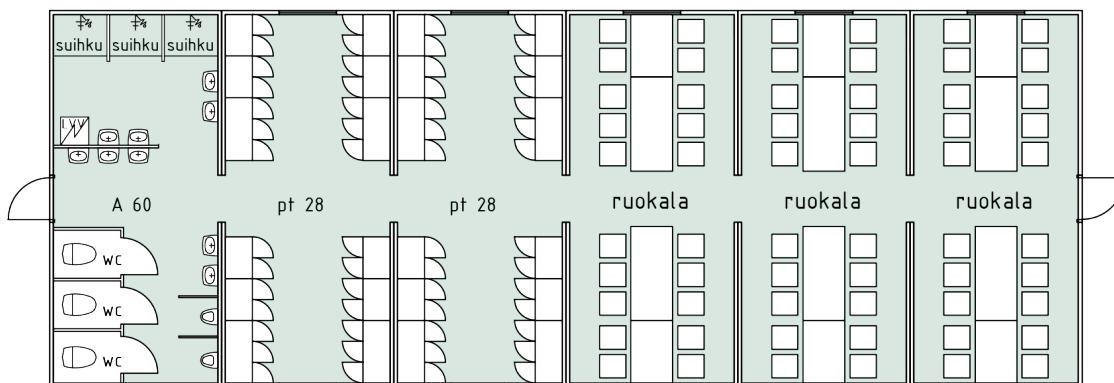
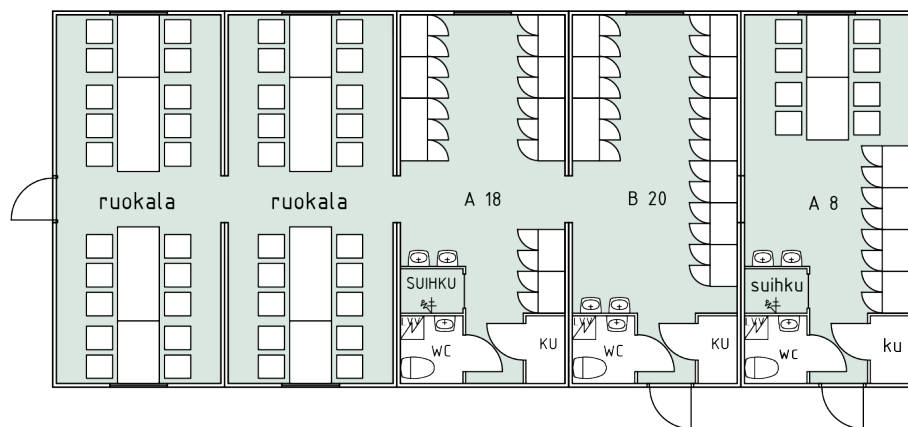

## Toimistotilat

